

# HIGHFOREST

by mirvac

## IRONBARK

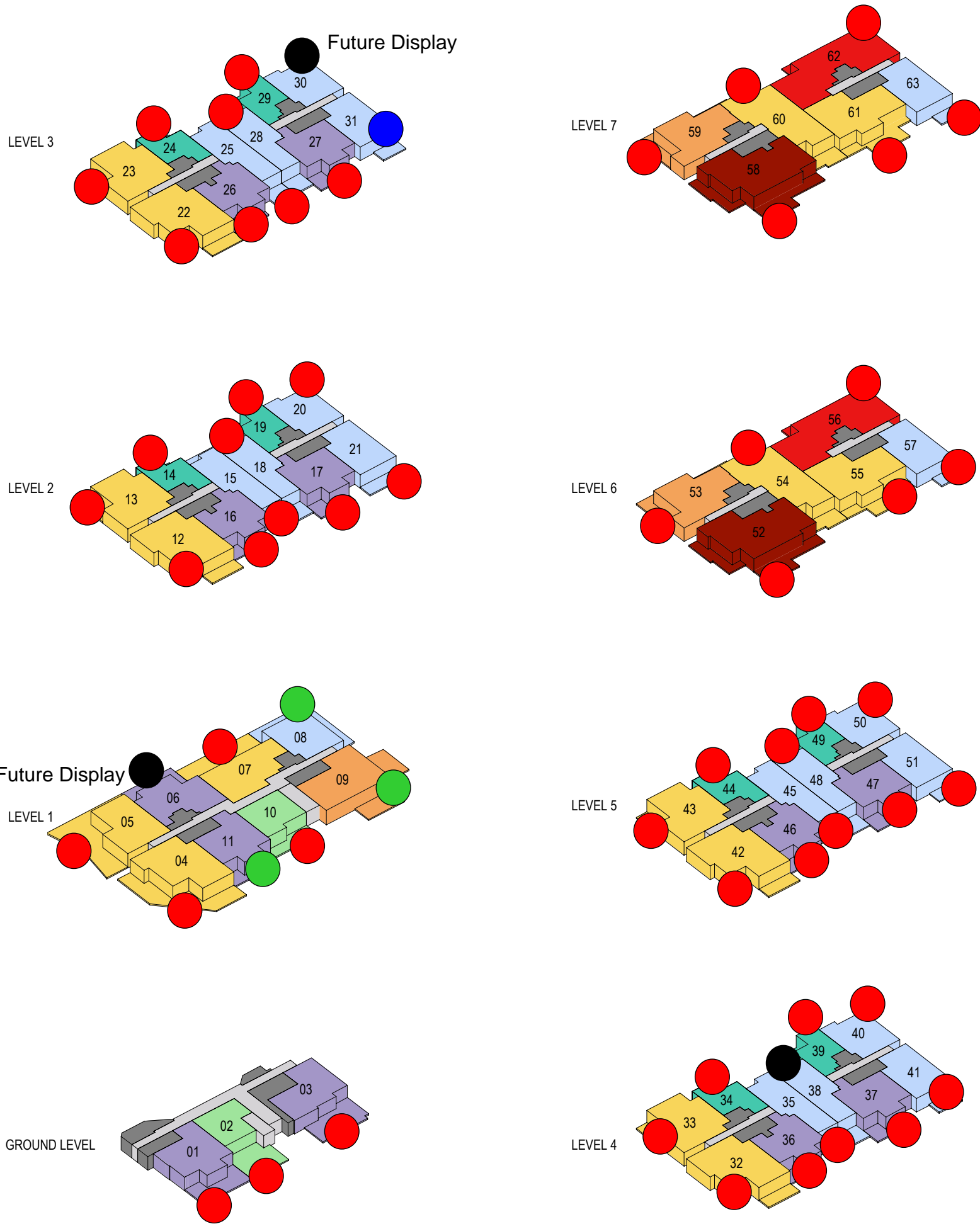

- |   |   |   |  |
|---|---|---|--|
| <span style="color: cyan;">■</span> 1 Bedroom Apartment               | <span style="color: purple;">■</span> 2 Bedroom + Media Apartment | <span style="color: orange;">■</span> 3 Bedroom + Study Apartment | <span style="color: lightgrey;">■</span> Lobby |
| <span style="color: lightgreen;">■</span> 1 Bedroom + Media Apartment | <span style="color: yellow;">■</span> 3 Bedroom Apartment         | <span style="color: red;">■</span> 4 Bedroom + Media Apartment    | <span style="color: grey;">■</span> Services   |
| <span style="color: lightblue;">■</span> 2 Bedroom Apartment          | <span style="color: gold;">■</span> 3 Bedroom + Media Apartment   | <span style="color: brown;">■</span> 4 Bedroom + Study Apartment  |  |

- |  |   |   |  |  |   |  |
|--|---|---|--|--|---|--|
| <span style="color: red;">●</span> Exchanged Unconditional | <span style="color: orange;">●</span> Exchanged Conditional | <span style="color: blue;">●</span> Deposit Taken |  | <span style="color: green;">●</span> Available | <span style="border: 1px solid black; border-radius: 50%; width: 15px; height: 15px; display: inline-block;"></span> Off Market | <span style="color: black;">●</span> Not Available |
| <span style="color: yellow;">●</span> Settled              |   |   |  |  |   |  |

# HIGHFOREST

by mirvac

## GRANDIS

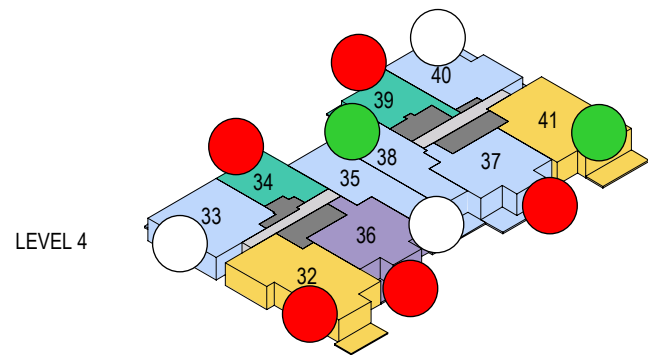
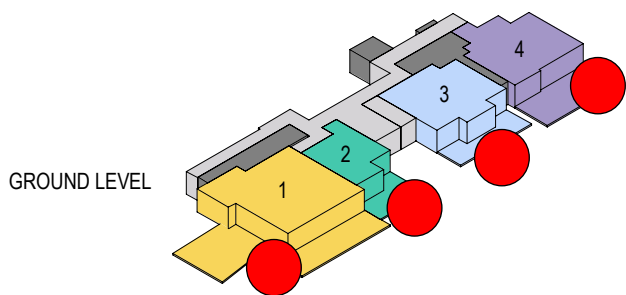
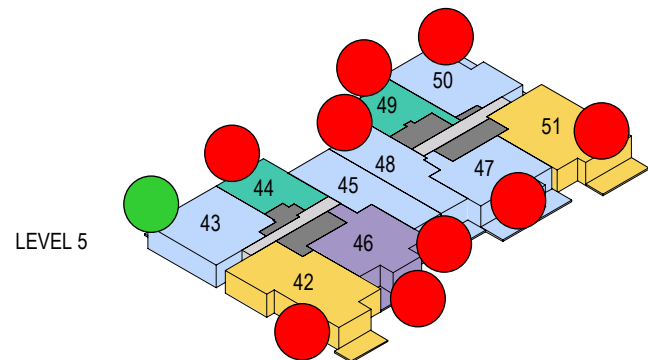
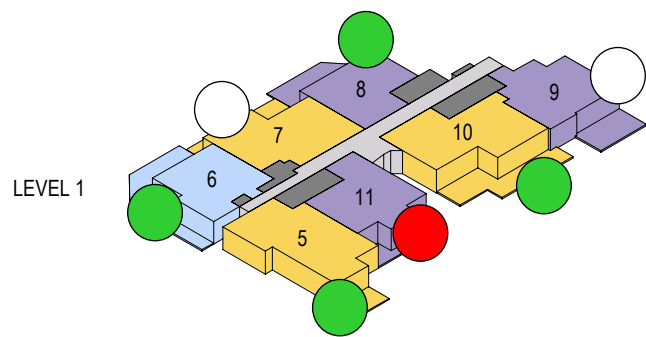
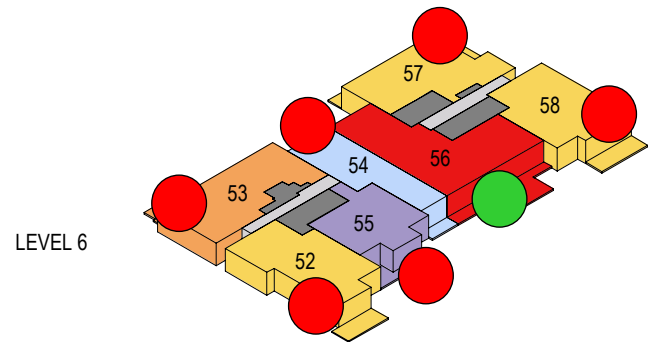
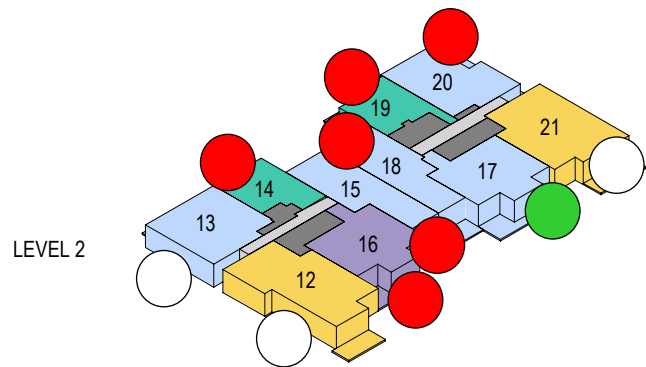
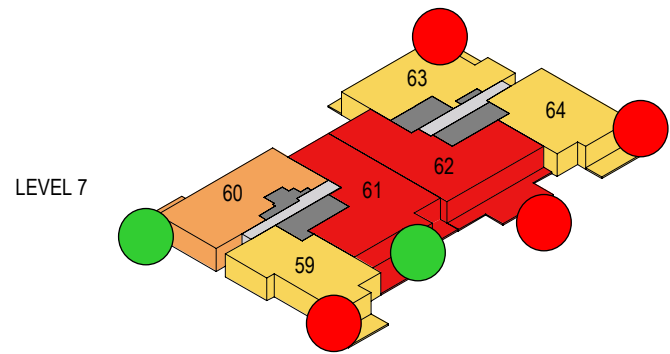
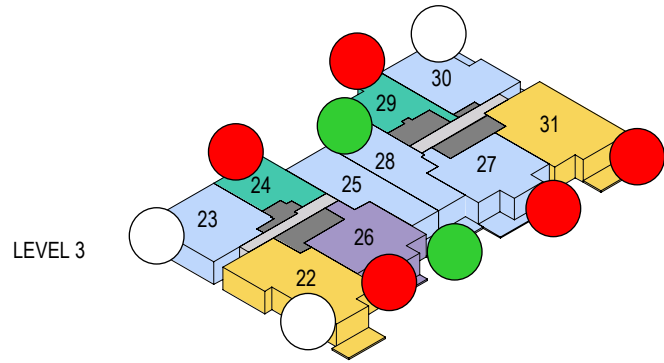

- |                             |                             |                             |          |
|-----------------------------|-----------------------------|-----------------------------|----------|
| 1 Bedroom Apartment         | 2 Bedroom + Media Apartment | 3 Bedroom + Study Apartment | Lobby    |
| 1 Bedroom + Media Apartment | 3 Bedroom Apartment         | 4 Bedroom + Media Apartment | Services |
| 2 Bedroom Apartment         | 3 Bedroom + Media Apartment | 4 Bedroom + Study Apartment |          |



- |                         |                       |               |  |           |            |               |
|-------------------------|-----------------------|---------------|--|-----------|------------|---------------|
| Exchanged Unconditional | Exchanged Conditional | Deposit Taken |  | Available | Off Market | Not Available |
|-------------------------|-----------------------|---------------|--|-----------|------------|---------------|

- Settled

# HIGHFOREST

## BLUEGUM

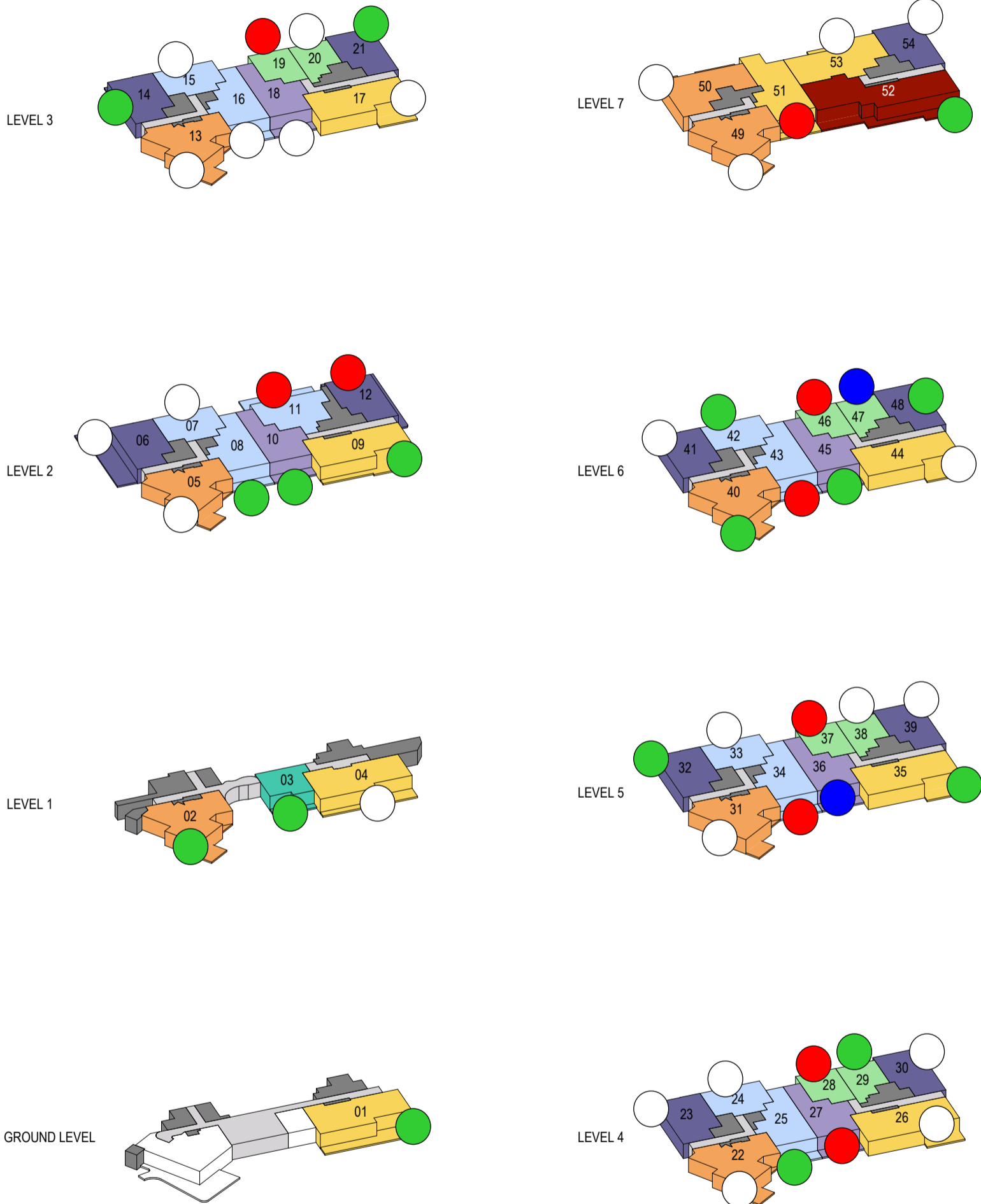

- |   |   |  |  |
|---|---|--|--|
| <span style="color: teal;">■</span> 1 Bedroom Apartment               | <span style="color: purple;">■</span> 2 Bedroom + Media Apartment   | <span style="color: orange;">■</span> 3 Bedroom + Study Apartment  | <span style="color: lightgrey;">■</span> Lobby   |
| <span style="color: lightgreen;">■</span> 1 Bedroom + Media Apartment | <span style="color: darkblue;">■</span> 2 Bedroom + Study Apartment | <span style="color: darkred;">■</span> 4 Bedroom + Study Apartment | <span style="color: darkgrey;">■</span> Services |
| <span style="color: lightblue;">■</span> 2 Bedroom Apartment          | <span style="color: yellow;">■</span> 3 Bedroom + Media Apartment   |  | <span style="color: white;">□</span> Amenity     |



13-06-2025 [B]

- |  |   |   |  |   |  |
|--|---|---|--|---|--|
| <span style="color: red;">●</span> Exchanged Unconditional | <span style="color: orange;">●</span> Exchanged Conditional | <span style="color: blue;">●</span> Deposit Taken | <span style="color: green;">●</span> Available | <span style="color: white;">○</span> Off Market | <span style="color: black;">●</span> Not Available |
|--|---|---|--|---|--|

- |   |
|---|
| <span style="color: yellow;">●</span> Settled |
|---|



# HIGH FOREST

## EUCALYPT

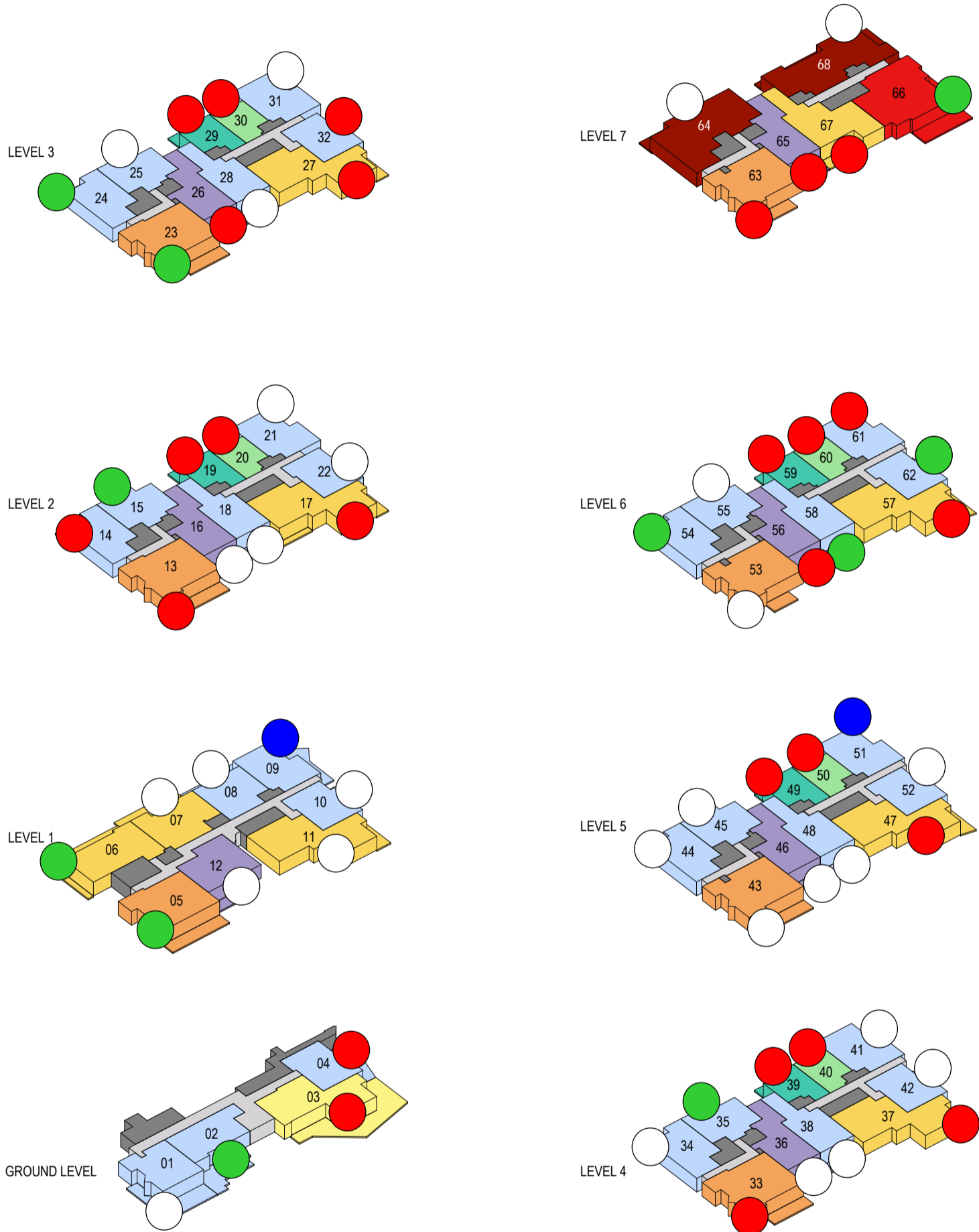

- |  |  |  |   |
|--|--|--|---|
| <span style="color: #008080;">■</span> 1 Bedroom Apartment         | <span style="color: #666699;">■</span> 2 Bedroom + Media Apartment | <span style="color: #FFA500;">■</span> 3 Bedroom + Study Apartment | <span style="color: #D3D3D3;">■</span> Lobby    |
| <span style="color: #90EE90;">■</span> 1 Bedroom + Media Apartment | <span style="color: #FFFF99;">■</span> 3 Bedroom Apartment         | <span style="color: #FF0000;">■</span> 4 Bedroom + Media Apartment | <span style="color: #666666;">■</span> Services |
| <span style="color: #ADD8E6;">■</span> 2 Bedroom Apartment         | <span style="color: #FFD700;">■</span> 3 Bedroom + Media Apartment | <span style="color: #8B0000;">■</span> 4 Bedroom + Study Apartment |   |



13-06-2025 [B]



- |  |  |  |  |   |  |
|--|--|--|--|---|--|
| <span style="color: #FF0000;">●</span> Exchanged Unconditional | <span style="color: #FFA500;">●</span> Exchanged Conditional | <span style="color: #0000FF;">●</span> Deposit Taken | <span style="color: #008000;">●</span> Available | <span style="color: #FFFFFF;">●</span> Off Market | <span style="color: #000000;">●</span> Not Available |
| <span style="color: #FFFF00;">●</span> Settled                 |  |  |  |   |  |

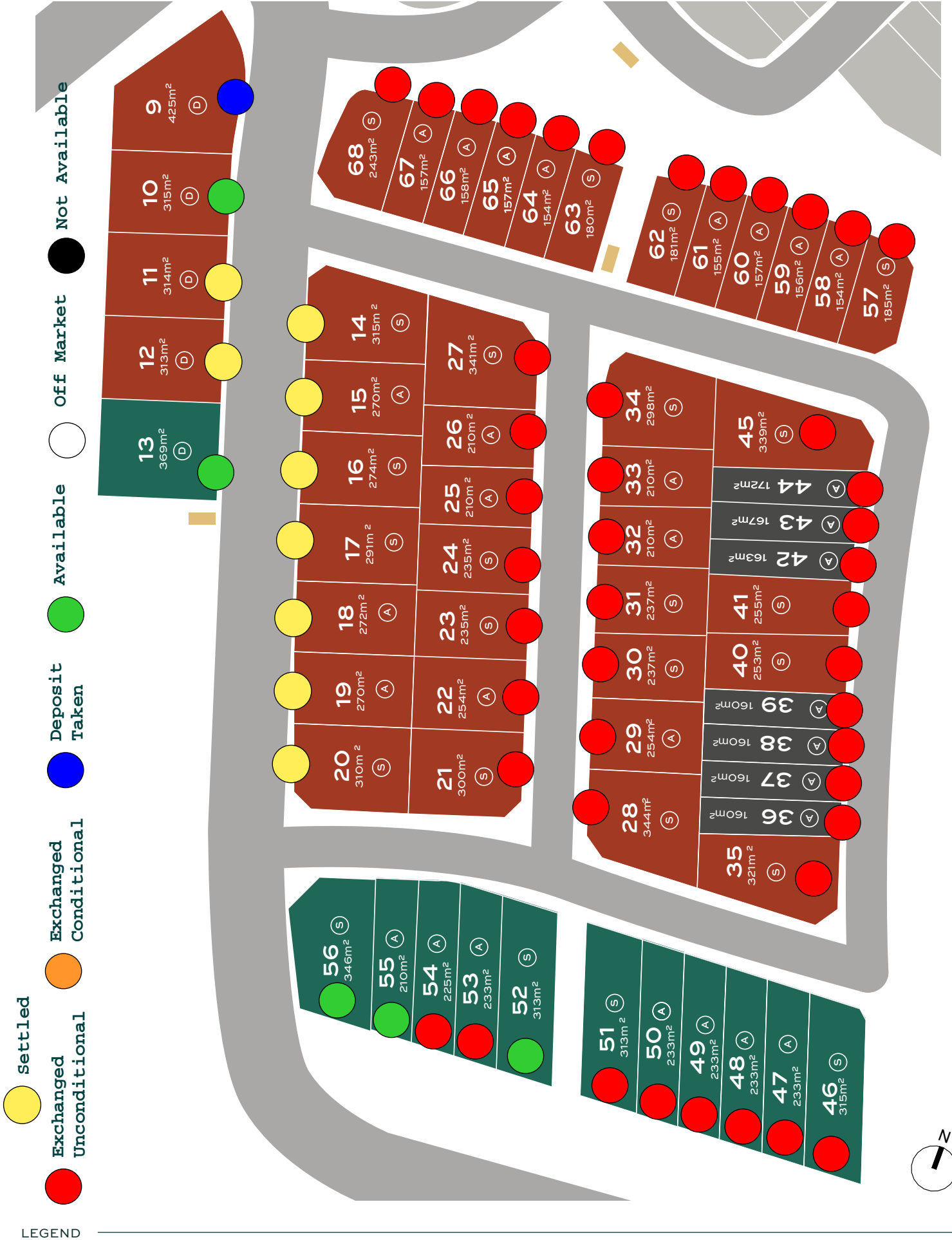

LEGEND

- 3 BEDROOM
- 4 BEDROOM
- 5 BEDROOM
- (A) ATTACHED
- (S) SEMI-ATTACHED
- (D) DETACHED
- SUB STATION
- FUTURE DEVELOPMENT
- SOLD

# HIGHFOREST

## HOUSING CENTRAL & NORTH

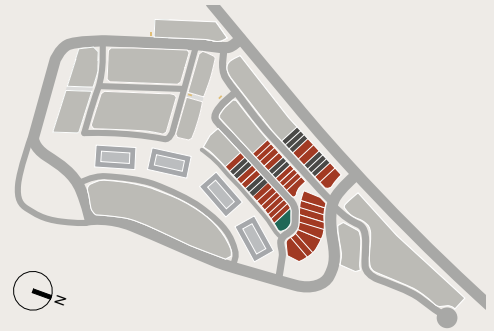

This precinct plan was prepared on 10/12/25 for the information of prospective purchasers only and is subject to change. Purchasers must make and rely on their own enquiries. To the extent of inconsistency between this masterplan and the conditions of the Contract For Sale of Land relating to the lots, the Contract for Sale takes precedence in all instances. Mirvac does not give any warranty or make any representations, expressed or implied about the completeness or accuracy of any information in this document or provided in connection with it. This document is not binding on Mirvac and is not intended to be relied upon. Mirvac expressly disclaims any and all liability relating to, or resulting from, the use of, or reliance on, any information contained in this document by any persons. Prepared as at 10/12/25

### LEGEND

- 3 BEDROOM
- 4 BEDROOM
- 5 BEDROOM
- A ATTACHED
- S SEMI-ATTACHED
- SUB STATION
- FUTURE DEVELOPMENT



HIGHFOREST.MIRVAC.COM

